



PROPERTIES.PRO

In a caring relationship with Real Estate

+34623013895 / +358 50 395 6616

info@proproperties.pro

PRO2098G



Town House in El Verger

€410,000



Planta Baja | Ground Floor



Planta 1 | Floor 1



Residual
25

Usable Area 90,13m²
Terrace area (Total, Garden area) 79,70m²
Entrance area (Total, Garden) 28,89m²
Built Area (Total, Terrace) 148,70m²
Superficie construida (Total, Terrace)

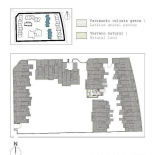

3



2



115m²



47m²



✓

NEW BUILD RESIDENTIAL IN EL VERGEL New Build residential complex of 65 modern 2 bedrooms apartments and 2 and 3 bedrooms townhouses in El Vergel. Following the sustainability and energy efficiency approach of residential complex the designers have created a project where terraced single-family homes predominate. This residential concept provides an environment where communal spaces are acc...(Ask for More Details!)

www.proproperties.pro

